

2023 CATALOG  
PARROT





MAKES YOUR LIFE BETTER - PARROT - CRAFTED FURNITURE THAT

101  
PARROT  
C.F.

CRAFTED IN SMALL BATCHES

# PARROT

The passion and love for our work inspired us to create furniture that is beautiful, comfortable and inspiring, seeking to generate well-being and quality of life for our clients.

We focus on creativity and commitment to design and make furniture of excellence, in constant interaction with our clients to promote innovation and go beyond a commercial relationship.

We establish an alliance between our business partners and end customers based on our work done with the honesty and integrity of our entire team and the people who work with us.

Committed to the social environment and the environment, we use wood and materials produced in a sustainable way and by merging with modern manufacturing techniques and fine labor-intensive artisanal processes, we produce unique and exclusive decoration accessories and furniture.







# Goosander mirror

---



We feature the Goosander Mirror with a meticulously carved wooden frame with elegant etched curves, adding a touch of sophistication and beauty to the piece.

It transforms it into not just a functional mirror but also a decorative work of art.

01

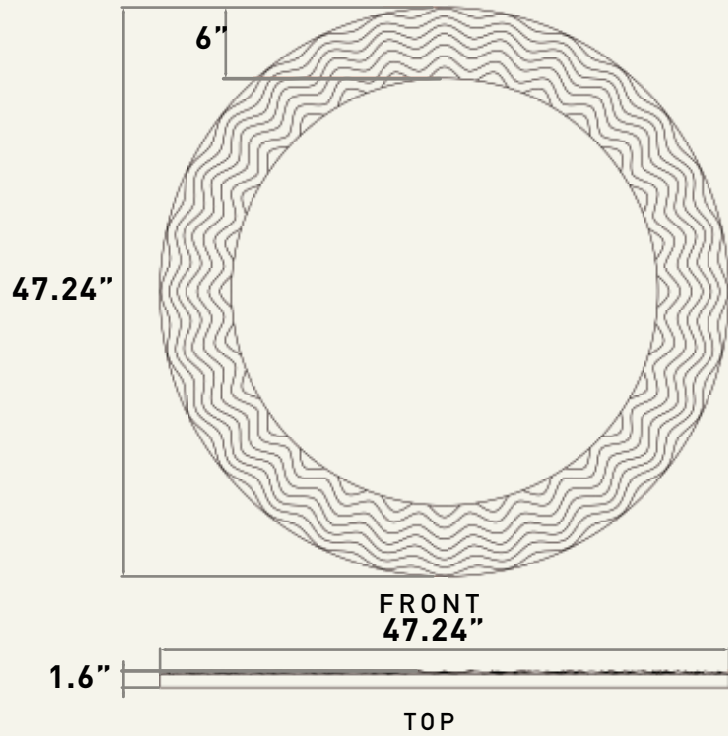

**DESCRIPTION**  
GOOSANDER MIRROR

- Round solid tabebuia wood framework with engraving in small curves.
- The mirror inside is perfectly fitted in the middle of the frame.

1x	47.24" D	
	GOOSANDER MIRROR	MATERIAL

AGED LAMINATE & WOOD



# Woodpecker mirror

---



The Woodpecker mirror with its distinctive, irregular frame, it will transform any space into something truly unique.

The wood is carefully selected and left in its natural state, preserving the unique textures and imperfections that give it character.



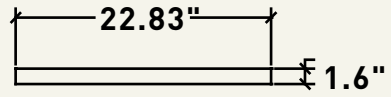

TOP

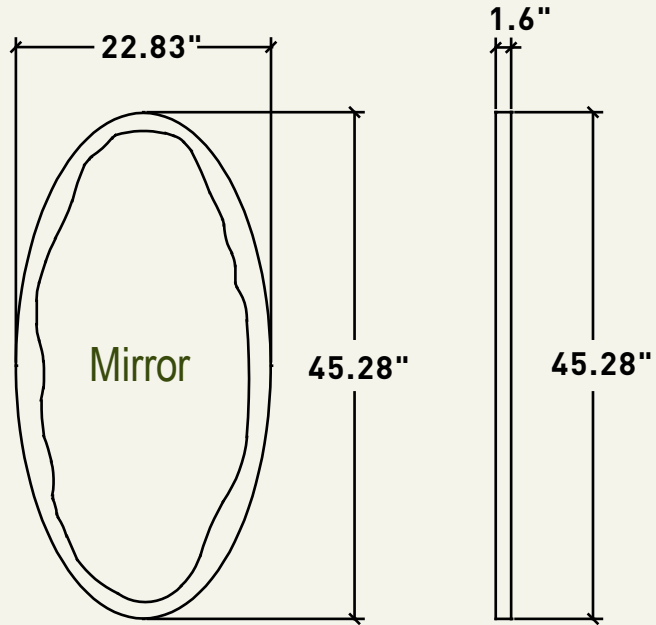

FRONT

RIGHT

## DESCRIPTION

### WOODPECKER MIRROR

- Mirror with tabebuia rosé wood frame.
- Mirror in its natural state.

1x	22.83" x 45.28"H	
	WOODPECKER MIRROR	MATERIAL

### WOOD & MIRROR



# Avocet mirror

---



## Avocet Mirror

The Avocet Mirror is ideal for decorating a living room or a dining room with these rectangular panes.

Our antique glass finish creates the look of an item uniquely marked by time.



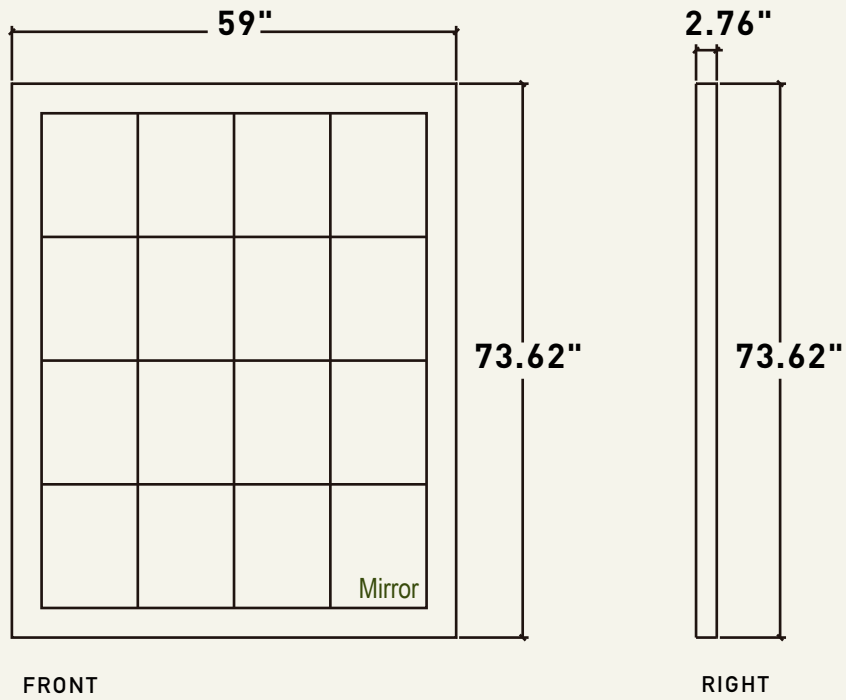

## DESCRIPTION

### AVOCET MIRROR

- Mirror with aged effect and Tabebuia rose wood frame.
- Mirrors inside with slight unevenness so that it can disfigure a little.

59" x 73.62" H

AVOCET MIRROR

MATERIAL

MIRROR & WOOD



# Iwii mirror

---



The versatile design of our Iwii Mirror is perfect for placement in various areas, including bathrooms, outdoor terraces, or any other location you can imagine.

Thanks to its size and design, it consistently serves as the perfect accent to elevate any space.

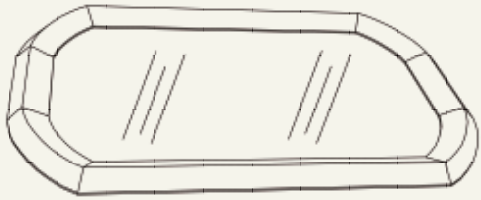

PERSPECTIVE

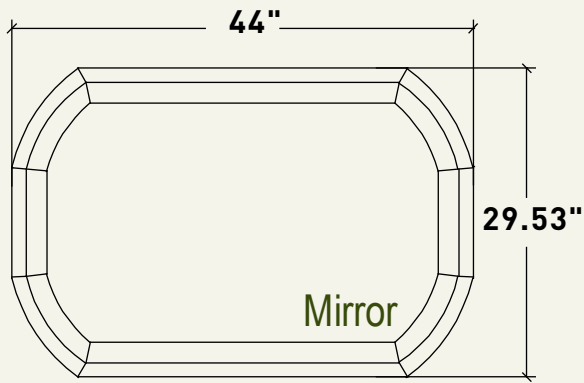

FRONT

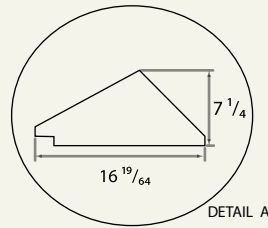

DETAIL A

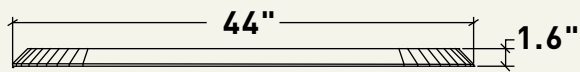

TOP



DETAIL A

RIGHT

## DESCRIPTION

### IWII MIRROR

- Octagonal mirror with a frame in carbon black finish with the beta of the wood marked and slight bumps.

1x	44" x 29.53" H
	IWII MIRROR

MATERIAL

WOOD & MIRROR







# Dotterel mirror

---



Our rustic aesthetic Dotterel Mirror made of laminate sheets and wood is the perfect combination of natural materials that fit together to create such a special and unique piece making it one-of-a-kind.

Since we use natural materials none of the pieces are exactly the same.

05

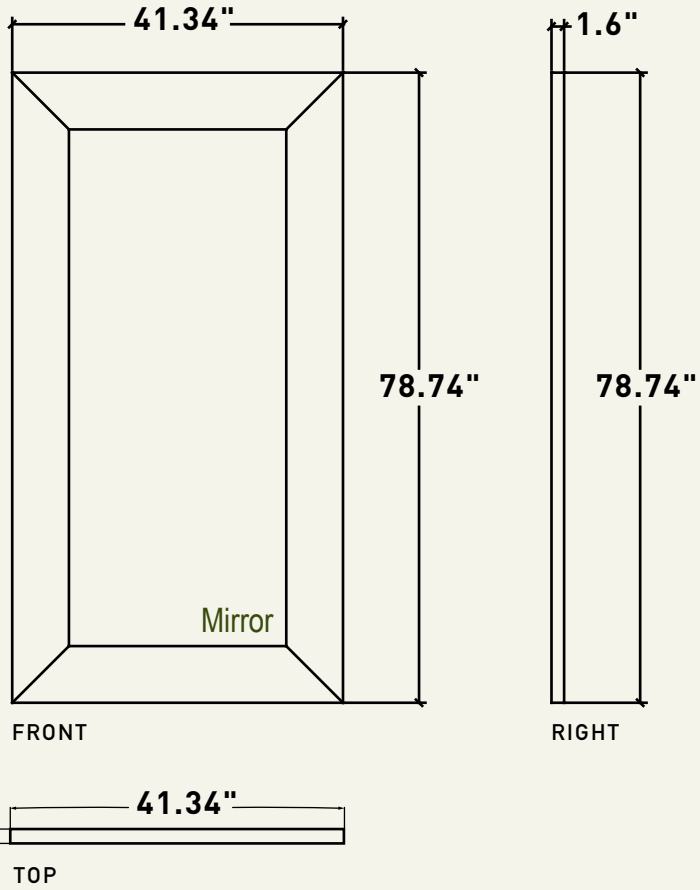

**DESCRIPTION**  
GOOSANDER MIRROR

- Solid wood frame with a vintage finish to create an aged appearance.
- Mirror.

1x	41.34" x 78.74" H
	DOTTOREL MIRROR

MATERIAL

WOOD & MIRROR



# Dove floor lamp



Presenting you our one and only Dove floor lamp that features a subtle design with hand-finished smithy and wood base.

The linen shades we chose, add an element of softness to warmly illuminate your space.

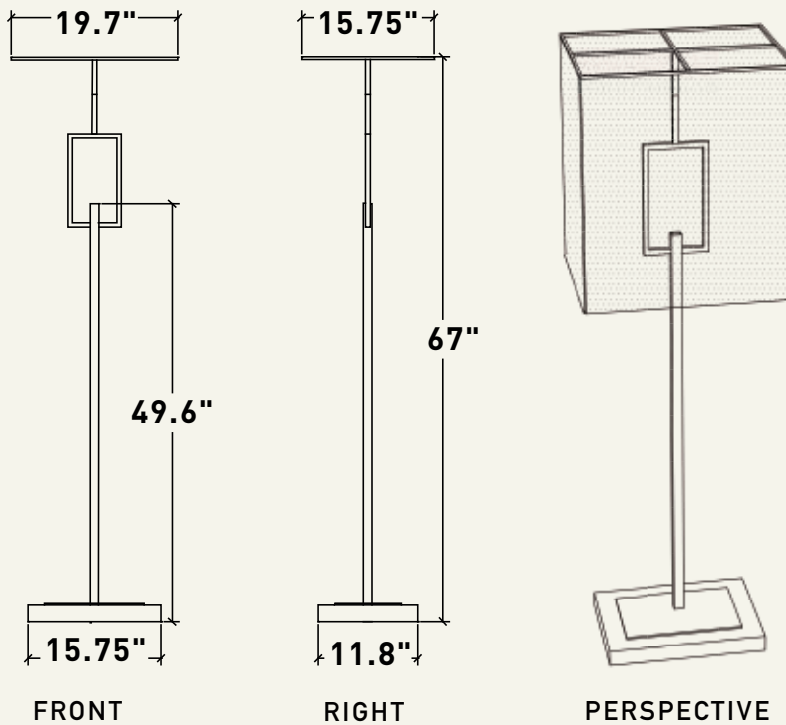

## DESCRIPTION

### WOODPECKER MIRROR

- Black steel body with aged effect.
- Shade made with fabric.
- Torched tebebuia rose wood base.

1x	19.7" x 15.75" x 67" H	MATERIAL
	DOVE LAMP	

WOOD & STEEL





# Roseate pedestal



A piece that is a work of art in itself, the Roseate pedestal will help you elevate any space, whether it's your living room, dining room, terrace, or entrance area.

You can also adorn it with a piece of art, a vase, a plant pot, a lamp, or simply leave it as it is. Its rustic design adds an iconic and timeless touch to your decor.

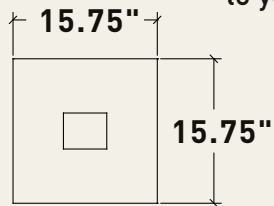

FRONT

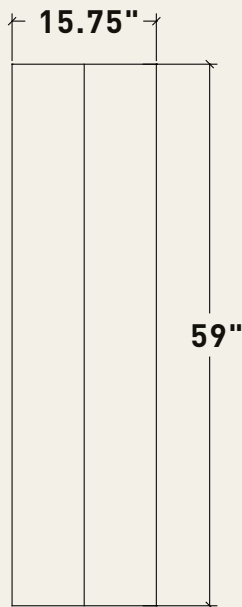

FRONT

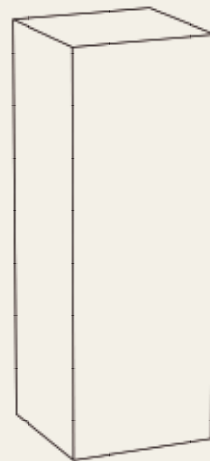

PERSPECTIVE



## DESCRIPTION

### ROSEATE PEDESTAL

- Long wooden cube with plugs at the top and a connector at the bottom, in a torched charcoal finish with the marked beta of the wood.

2x	15.75" X 15.75" X 43.3"H		15.75" X 15.75" X 59"H
	ROSEATE PEDESTAL S/L		MATERIAL

WOOD





# Rosella Easel



The Rosella Easel is an exceptionally unique and aesthetically pleasing piece that can be placed in various locations, such as a home's hallway or living room.

It is designed to perfectly display a piece of art.

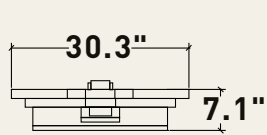

TOP

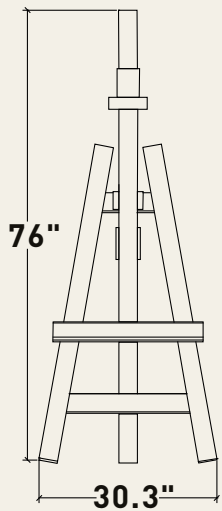
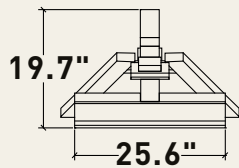

FRONT

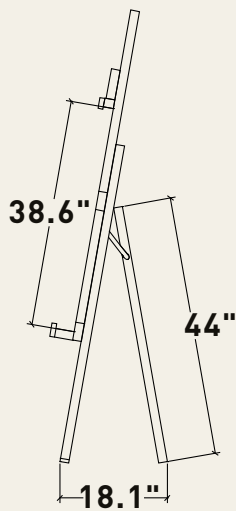

RIGHT

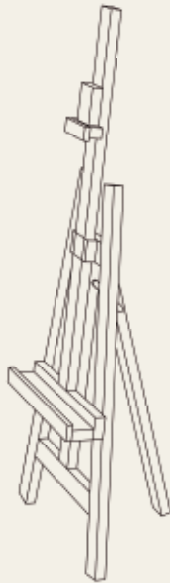

PERSPECTIVE



## DESCRIPTION ROSELLA EASLE

- Made of Tabebuia rosewood and left with the imperfections that come with it making all pieces slightly different.

1x	30.3" x 76" H	MATERIAL
	ROSELLA EASLE	

WOOD



# Inky cockatiel cabinet



A solid wood cabinet that Works in any space and can be used in completely different ways.

A piece created with the combination of torched wood and steel is what gives it a unique character.

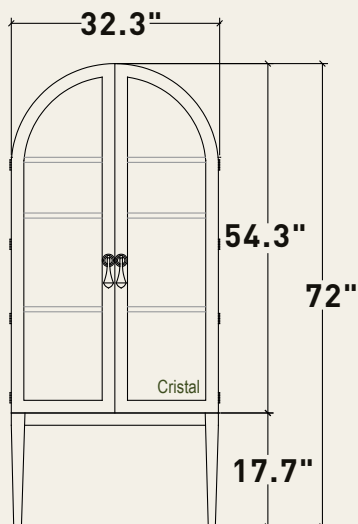

FRONT

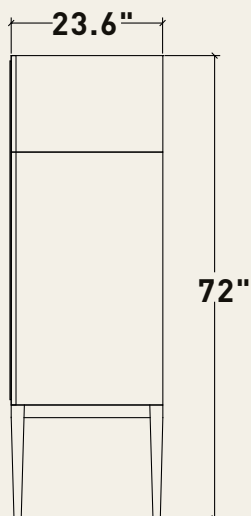

RIGHT



PERSPECTIVE



## DESCRIPTION

### INKY COCKATIEL CABINET

- Made out of aged wood in ash black with a wrought iron base in its natural state with two doors with a wooden front.
- Compartments inside for the function that each person wants to give it.

1x	32.3" X 23.6" X 72"H
	INKY COCKATIEL CABINET MATERIAL

WOOD & GLASS





# Lorikeet console



The design of our handmade Lorikeet Console combines rustic and modern elements, making it incredibly versatile for placement anywhere you desire.

Its straightforward design lends an elegant and distinctive touch to both your interior and outdoor spaces.

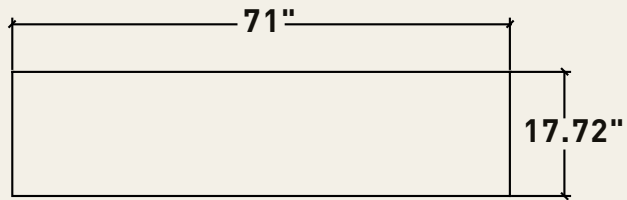

TOP

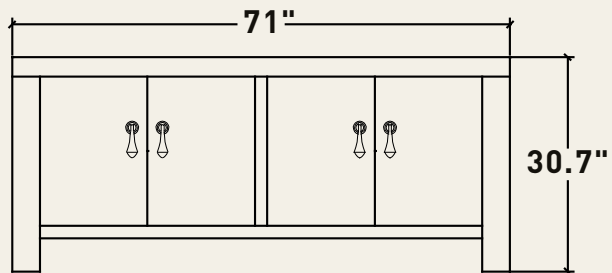

FRONT

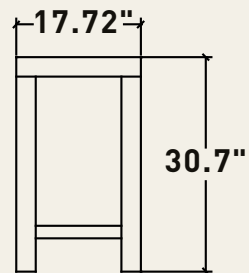

RIGHT

## DESCRIPTION

### LORIKEET CONSOLE

- Weathered distressed finish on front and sides.
- Special Parrot design on the buffet handles.

1x	71" x 17.72" x 30.7" H	MATERIAL
	LORIKEET CONSOLE	

WOOD





# Parrotlet pedestal



A pedestal with a unique and distinctive design, the Parrotlet stands out not only for its aesthetics but also for its functionality and adaptability to the use you want to give it.

Whether you want to place a cage, a decorative object, a work of art, or a plant pot, the Parrotlet will add that extra touch to your decor with its adjustable height system, allowing you to achieve the desired volume in your space.

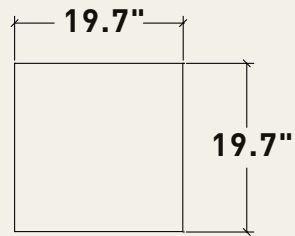

TOP

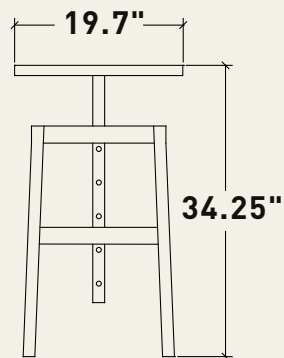

FRONT

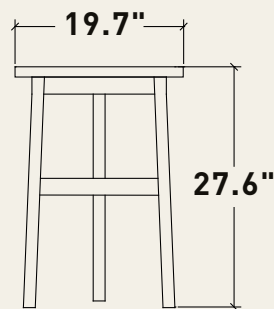

RIGHT

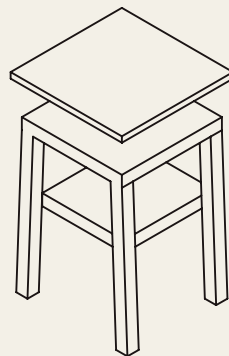

PERSPECTIVE



## DESCRIPTION

### PARROTLET PEDESTAL

- A solid Tabebuia Rosewood pedestal with a torched finish.
- Hand picked wood making every piece unique by leaving the natural bumps in the wood come with it.

1x	180 X 78	MATERIAL
	PARROTLET PEDESTAL	

WOOD



# Linnet side table



Our Linnet side table has a design that just by placing it in a space is the perfect complementary accent you need to make a difference or lift the environment due to its fine curves and wooden finish.

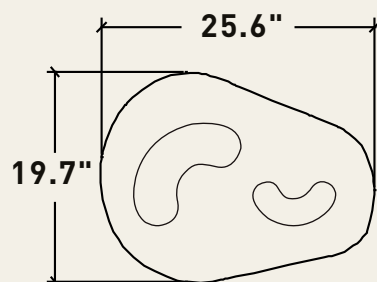

TOP



PERSPECTIVE

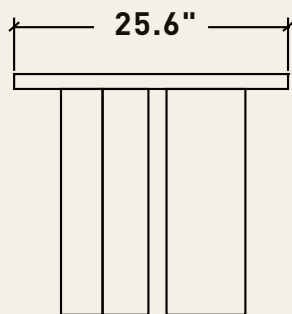

FRONT

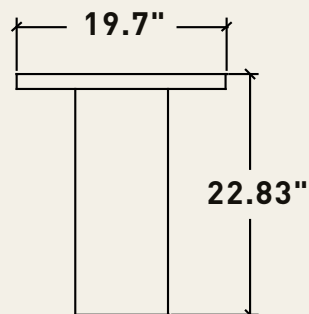

RIGHT

## DESCRIPTION LINNET SIDE TABLE

- Table made of rough and aged solid Tabebuia rosewood.
- The shape of the cover has fine curves.

1x	25.6" X 19.7" X 22.83"H	MATERIAL
	LINNET SIDE TABLE	





# Jackdaw side table



The genuine Jackdaw side table is meticulously handcrafted by skilled artisans.

The tabletop is constructed from steel in its natural state, lending it a refined finish through polishing.

We take special care in selecting the wood for each piece, ensuring their uniqueness as we preserve the natural imperfections and bumps that come with it.

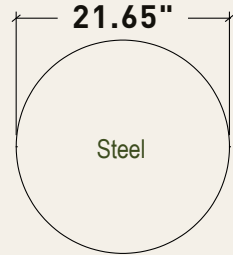

TOP

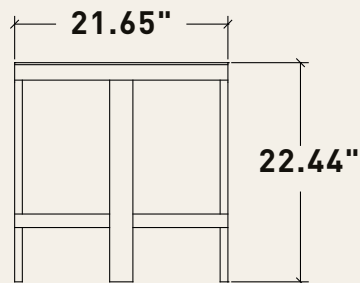

FRONT

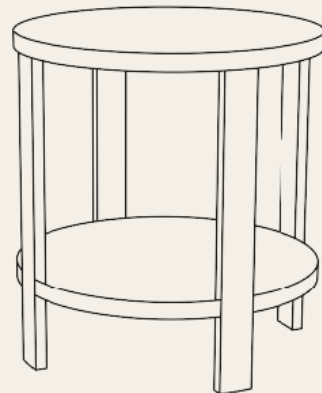

PERSPECTIVE



## DESCRIPTION

### JACKDAW SIDE TABLE

- Solid wood base with bumps and aged finish.
- Steel plate cover in its natural finish.

1x	21.65" X 22.44" H
	JACKDAW SIDE TABLE
MATERIAL	

WOOD & STEEL







# Mallard side table



Our Mallard side table showcases a harmonious blend of rustic and modern design elements, ensuring its versatility for placement in various settings.

Whether used as a side table in a living room, a nightstand, a complementary table in the bathroom, or any other way you envision, it is thoughtfully designed to excel in both form and function.

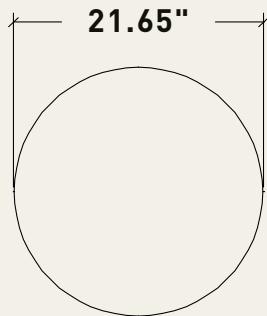

TOP

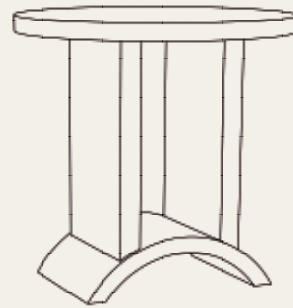

PERSPECTIVE

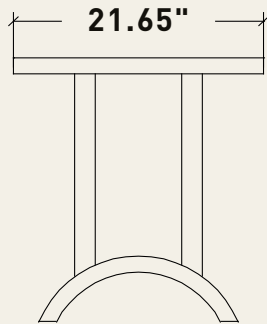

FRONT

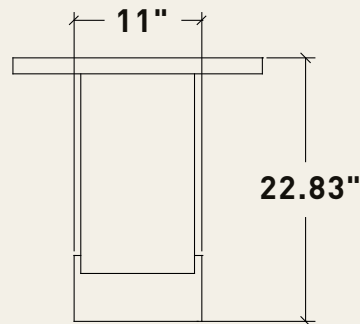

RIGHT



## DESCRIPTION

### MALLARD SIDE TABLE

- A round tabletop with a base formed by two wooden plates to place items between them.

1x	21.65" X 22.83" H	MATERIAL
	MALLARD SIDE TABLE	

WOOD



# Nightjar side table



Our Nightjar side table provides a wide range of placement options and opportunities for creative use.

For instance, it can be positioned between two chairs, placed next to a sofa, utilized as a nightstand, or even used as a complement to a coffee table, offering versatile functionality in various settings.

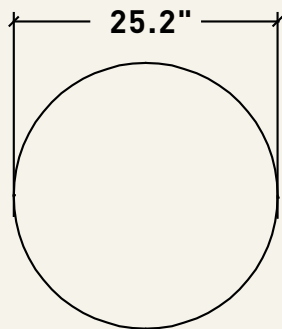

TOP

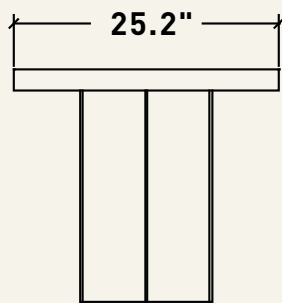

FRONT

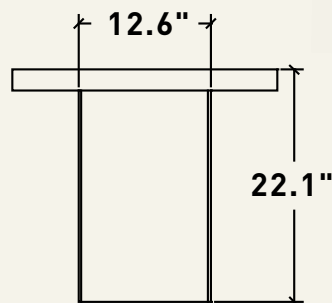

RIGHT

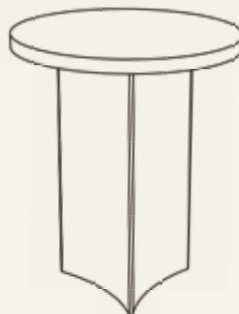

PERSPECTIVE

## DESCRIPTION

### NIGHTJAR SIDE TABLE

- Base in the shape of a triangle with angles on each face, the edges of the rounded joints.
- Made of torched Tabebuia rosewood.

1x	25.2"D X 22.1"H	MATERIAL
	NIGHTJAR SIDE TABLE	

WOOD





# Shoveler side table



It's the side table that will help you complete the space you were missing. With its semi-circular shape, the possibilities for placement are multiplied, whether against a wall, next to the sofa, as a bedside table, or in any other space you can imagine.

Its beautiful design that combines steel with wood will be the centerpiece of your space.

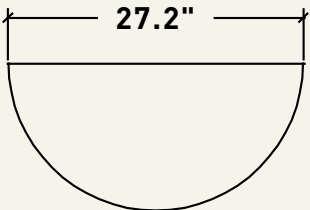

TOP

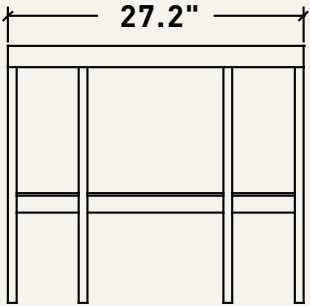

FRONT

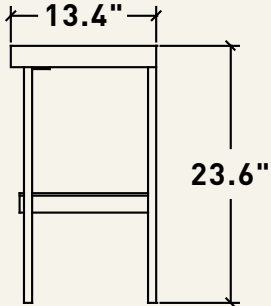

RIGHT

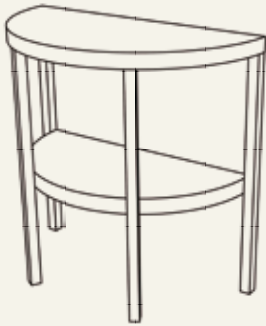

PERSPECTIVE

## DESCRIPTION

### SHOVELER SIDE TABLE

- Table made of distressed Tabebuia rose wood to achieve an aged look and steel, in a half-moon shape.

1x	27.2" X 13.4" X 23.6"H
	SHOVELER SIDE TABLE

MATERIAL

WOOD & STEEL







# Eagle side table



The eagle side table features intricately crafted legs resembling the graceful and powerful claws of parrots.

The bird-inspired design brings a touch of nature's beauty and elegance to your living space, making it a striking and unique addition to your decor.

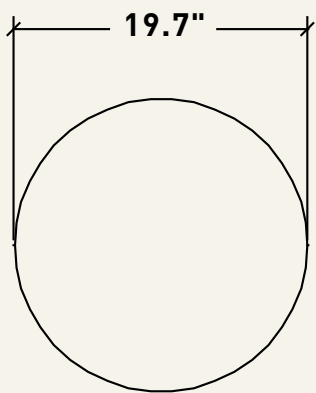

TOP

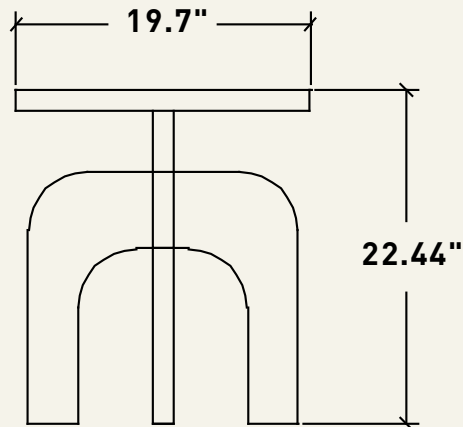

FRONT

## DESCRIPTION

### EAGLE SIDE TABLE

•Side table made of solid distressed Tabebuia rosewood to achieve an aged look.

1x	19.7" X 22.44"H
	EAGLE SIDE TABLE

MATERIAL

WOOD



# Hummingbird side table



The Humming bird side table will undoubtedly become a must-have in your life.

Adapting to any place where you put it, the Humming bird will facilitate your daily tasks, from eating, writing, working, to serving as a simple decorative element in your space.

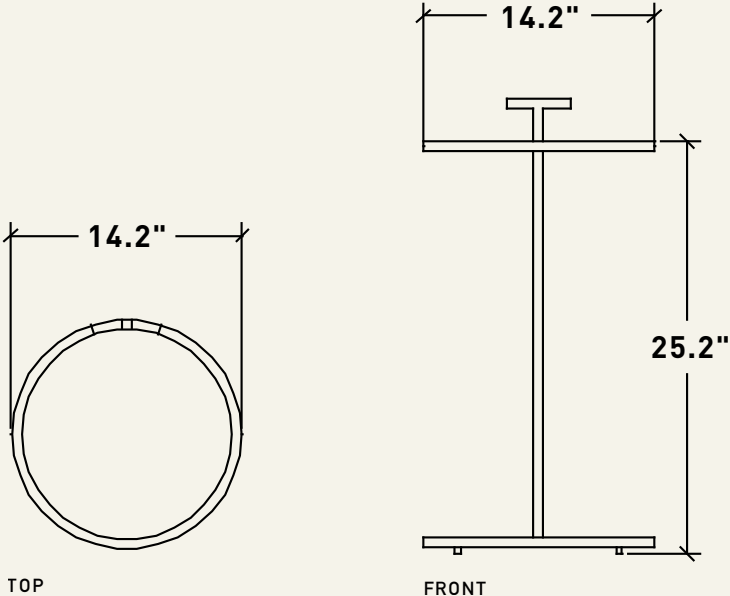

## DESCRIPTION HUMMING SIDE TABLE

- Side table made of steel with black finish.

1x	14.2" x 25.2"H	MATERIAL
	HUMMINGBIRD SIDE TABLE	
		STEEL



# Eclectus table



Inspired by the parrot's beak, the Eclectus table is the newest addition to this collection and promises to be a favorite.

It's a perfect choice for those looking to add a unique and bold touch to their decor while enjoying the comfort and durability offered by this solid wood-crafted masterpiece.

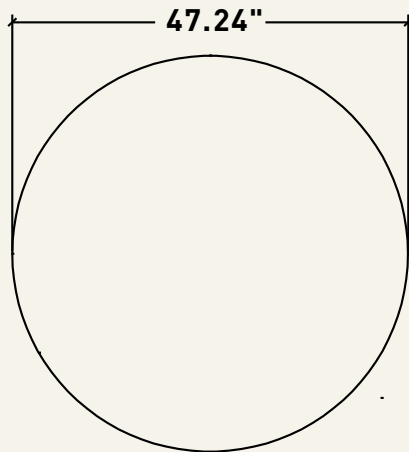

TOP

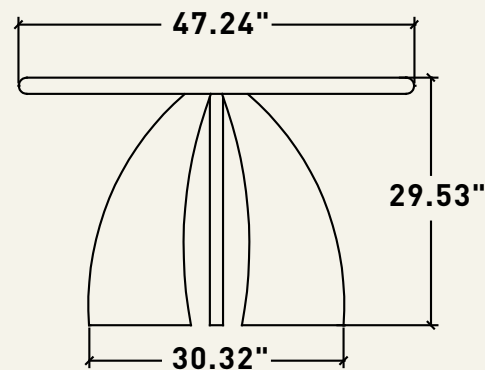

FRONT

## DESCRIPTION ECLECTUS TABLE

- Table made of distressed Tabebuia rose wood to achieve an aged look.
- Formed by three bases to provide greater stability.

1x	47.24" X 29.53" H	MATERIAL
	ECLECTUS TABLE	

WOOD

# Kingfisher bench



Our Kingfisher bench is crafted from solid Tabebuia rosewood, boasting a simple yet elegant design that effortlessly complements various spaces, allowing you to place it wherever you can envision.

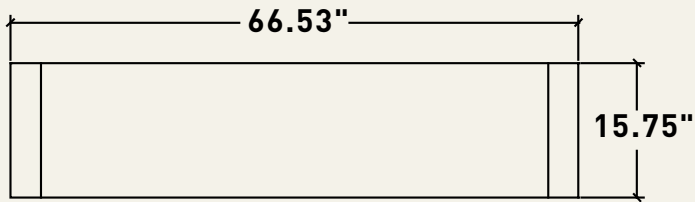

TOP

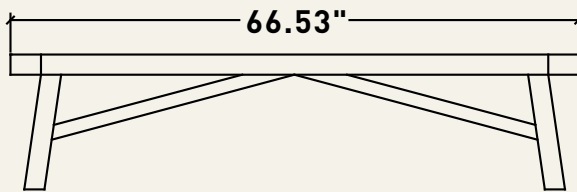

FRONT

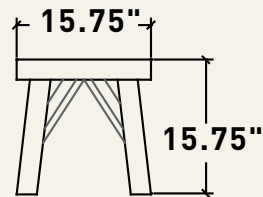

RIGHT

## DESCRIPTION KINGFISHER BENCH

- Bench in medium beaten worn finish, made of solid tabebuia rosewood.
- Handpicked making every piece unique by leaving the natural bumps in the wood come with it.

1x	66.53" X 15.75" X 15.75" H	MATERIAL
	KINGFISHER BENCH	

WOOD





# Conure console



Our Conure console is designed with a curved base structure, adding a sense of movement and a light appearance to the piece, which is contrasted by its thick countertop.

Without a doubt, it will be one of the standout pieces in your space.

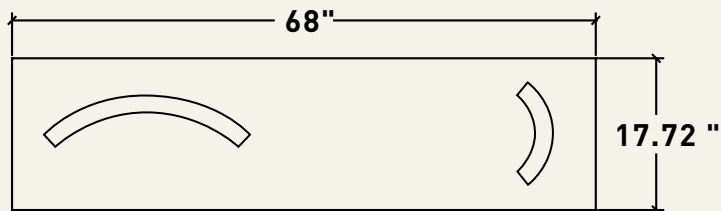

TOP

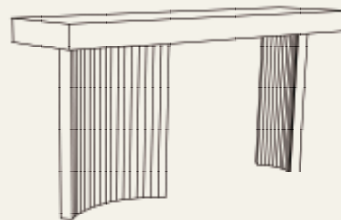

PERSPECTIVE

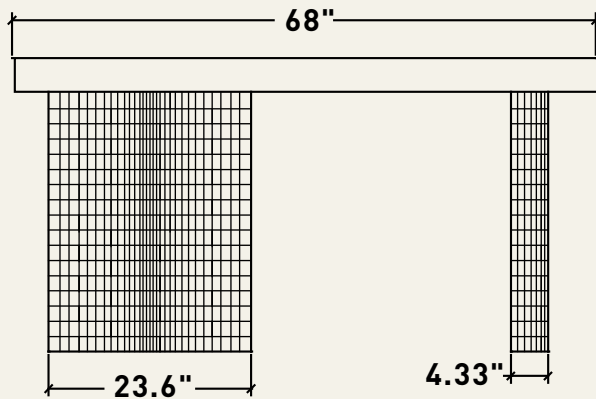

FRONT

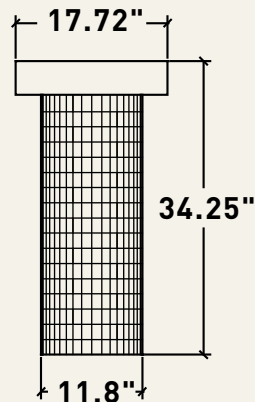

RIGHT

## DESCRIPTION CONURE CONSOLE

- Sturdy-looking solid wood cover with a flamed wood finish to highlight the grain.
- The curved solid wood legs exposing the texture of the wood on both sides.

1x	68" X 17.72" X 34.25"H	MATERIAL
	CONURE CONSOLE	



# Parakeets console



The Parakeets vintage-inspired console is meticulously handcrafted from carefully selected wood, making each piece unique in its own way.

We intentionally preserve the wood's natural imperfections and bumps to enhance the character of the piece.

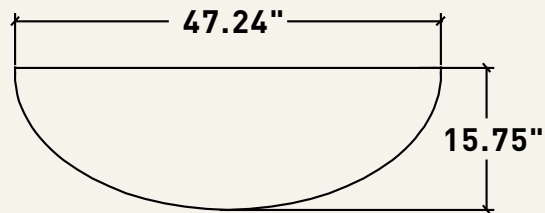

TOP

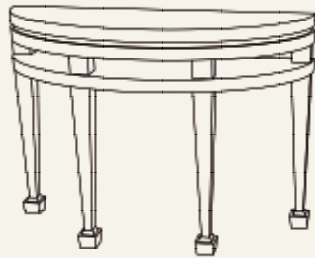

PERSPECTIVE

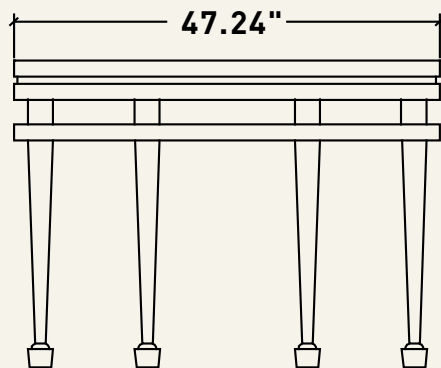

FRONT

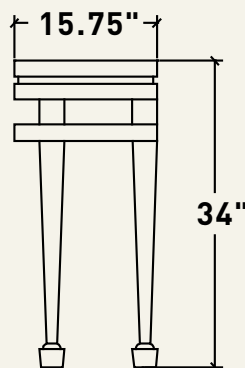

RIGHT



## DESCRIPTION

### PARAKEETS CONSOLE

- Completely made of solid wood, in an aged finish.
- With a very unique engraved detail on the legs and on the cover.

1x	47.24" X 15.75" X 34"H	MATERIAL
	PARAKEETS CONSOLE	
		WOOD





# Finch console



The Finch console is crafted from solid wood, to provide this heavy image of two monoliths supporting a lightweight cover.

The piece undergoes an artisanal process to achieve a rustic finish creating a unique centerpiece for your home's gathering space.

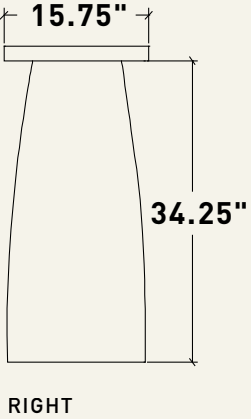
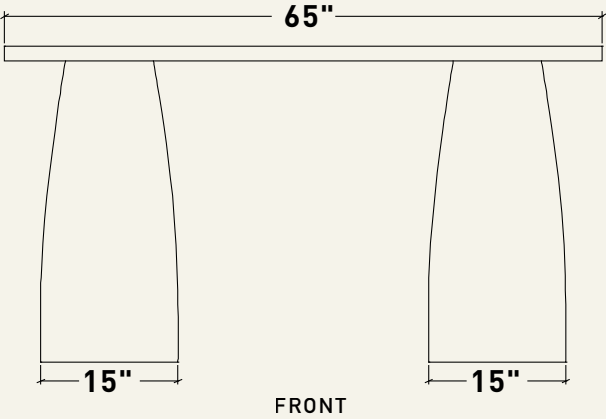
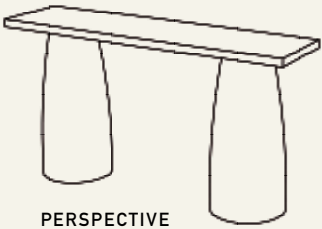

## DESCRIPTION

### FINCH CONSOLE

- 2 solid cylinder-shaped legs that are thicker at the bottom and thinner at the top.
- Solid Tabebuia rosewood cover.

1x	65" X 15.75" X 34.25" H	MATERIAL
	FINCH CONSOLE	





# Pionus sofa back console bench



The unique design of our Pionus offers great versatility, whether it's positioned in a home's hallway or behind a sofa, making it an essential piece for enhancing your space.

Its rustic modern design allows for easy and minimalist decoration.

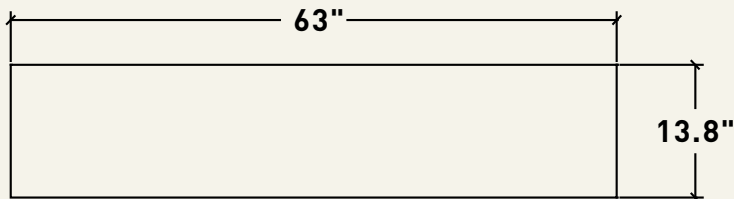

TOP

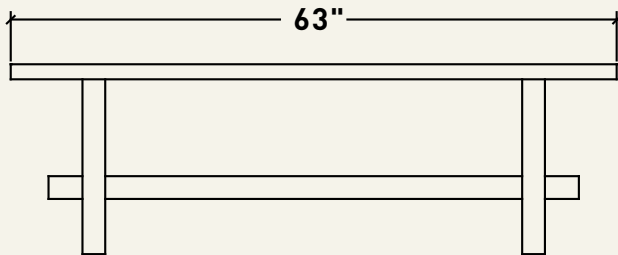

FRONT

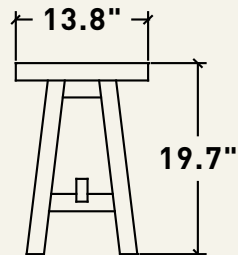

RIGHT

## DESCRIPTION

### PIONUS SOFA BACK CONSOLE BENCH

- Solid Tabebuia rosewood perfectly cut and fitted creating a solid sofa back console/ bench.

1x	63" X 13.8" X 19.7"H	MATERIAL
	PIONUS BENCH	



# Sungem coffee table



With a contemporary design and finish, our Sungem coffee table showcases a handcrafted steel base paired with Tabebuia rosewood in a sleek black carbon finish.

This versatility allows it to seamlessly fit into various spaces.

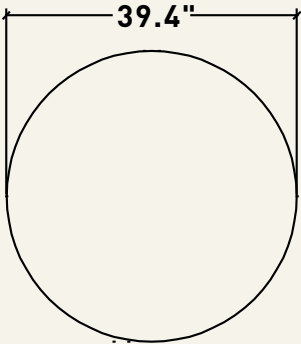

TOP

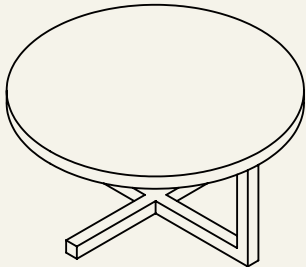

PERSPECTIVE

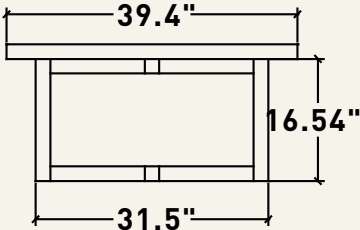

FRONT

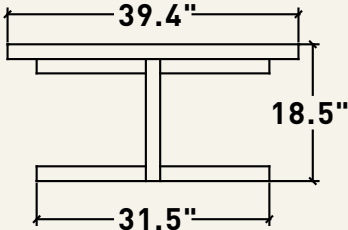

RIGHT



## DESCRIPTION

### SUNGEM COFFEE TABLE

- Coffee table with solid wood cover with blacksmith base in its natural state.
- The cover with a light slope type tray.

1x	39.4" X 18.5"H	MATERIAL
	SUNGEM COFFEE TABLE	

WOOD





# Barbet coffee table



Barbet coffee table speaks for itself. This rustic yet modern piece celebrates the beauty found in imperfections.

Crafted from solid wood in its natural state, each table retains its unique, original character, showcasing the distinct personality of the wood used.

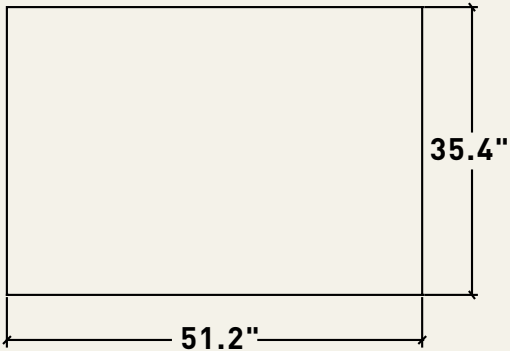

TOP

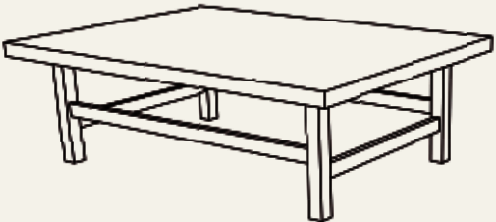

PERSPECTIVE

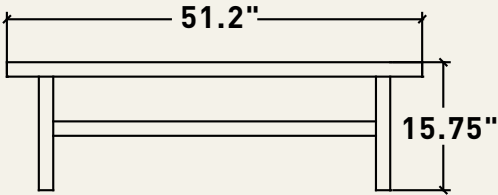

FRONT

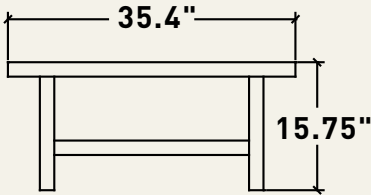

RIGHT

## DESCRIPTION

### BARBET COFFEE TABLE

- Solid wood table with an aged and lightly beaten feel with detailed engraving on the top.

1x	51.2" X 35.4" X 15.75"H	MATERIAL
	BARBET COFFEE TABLE	
		WOOD







# Malabar coffee table



The distinctive design of our Malabar coffee table, with its irregular shapes and fluid curves, sets it apart from typical coffee tables, making it an eye-catching accent piece for your space.

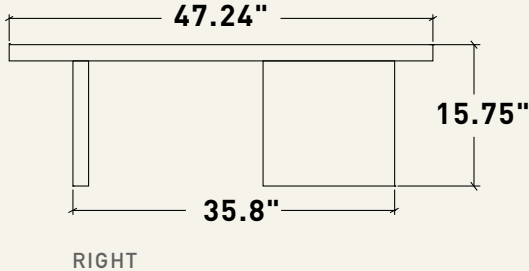
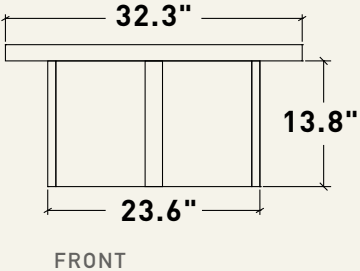
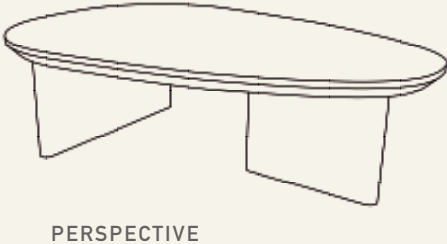
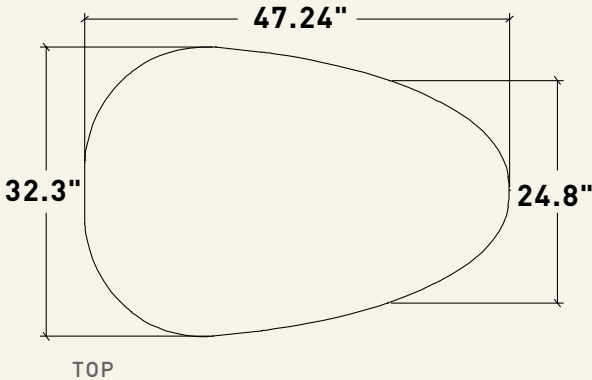

## DESCRIPTION

### MALABAR COFFE TABLE

- Solid Tabebuia rosewood table in carbon black color, with two solid legs of lightly beaten wood, the cover is solid and resistant.

1x	47.24" X 32.3" X 15.75"H
	MALABAR COFFE TABLE

MATERIAL

WOOD



# Cardinal coffee table



Functional design at its best, our Cardinal coffee table is a hand-crafted design that was first made in our PARROT line respecting the natural way of wood.

Very solid and rough for you to place it wherever you mostly need it. Giving a great uplift in the space.

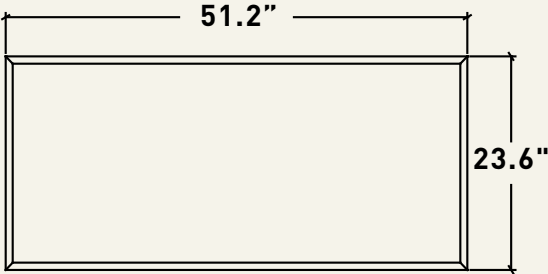

TOP

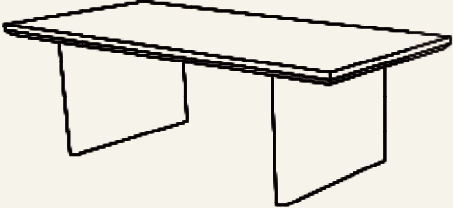

PERSPECTIVE

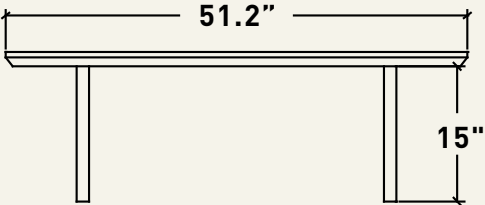

FRONT

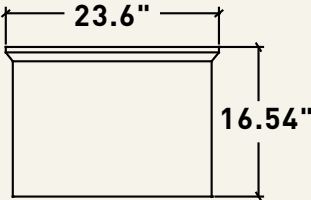

RIGHT

## DESCRIPTION

### CARDINAL COFFE TABLE

- Completely wooden table in Tabebuia solid rose wood making it perfect for rough use and still being elegant and timeless.

2x	51.2" X 23.6" X 16.54"H   63" X 24.4" X 16.54"H
	CARDINAL COFFE TABLE S   L MATERIAL

WOOD





# Pipiolo sofa



Indulge in luxury and comfort with our Pipiolo leather sofa.

Crafted from the finest, supple leather, its classic yet contemporary design seamlessly blends with any interior, from modern to traditional, making it the focal point of any space.

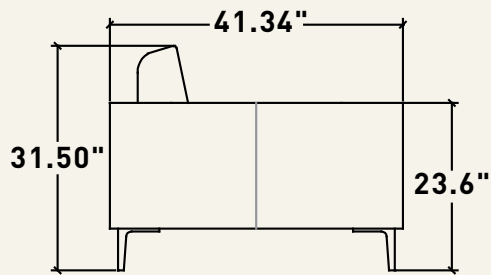

RIGHT

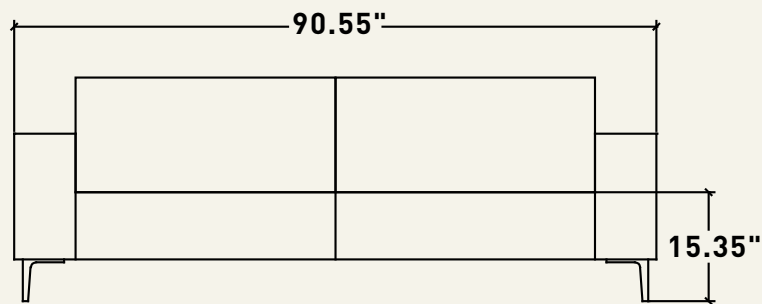

FRONT

## DESCRIPTION PIPIOLO SOFA

- Premium leather sofa.

1x	90.55" X 41.34" X 31.5"H	MATERIAL
	PIOLO SOFA	

LEATHER

# Budgie chair



The Budgie armchair is another clear example of Parrot's furniture versatility, as you can place it in any space you desire. Whether in your living room, dining area, entrance, or terrace, its cover gives it the look of a cozy chair that provides that warm, homely feel.

If you're aiming for a more casual or vintage appearance, this is the missing piece to complete your space.

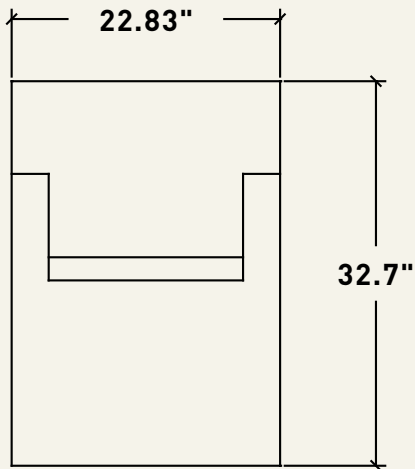

FRONT

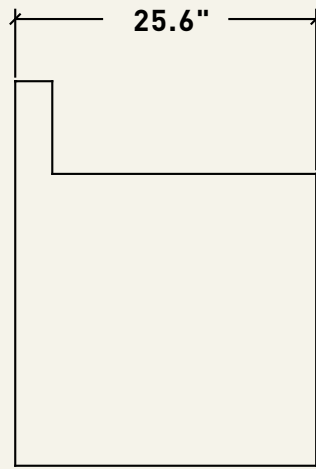

RIGHT

## DESCRIPTION BUDGIE CHAIR

- Armchair featuring a textile upholstery.

1x	22.83" X 25.6 X 32.7"H	MATERIAL
	BUDGIE CHAIR	

FABRIC



# Macaw chair



The Macaw chair is the perfect combination of durable comfort and style.

Whether in a living room, a home office, dining room, or any other space, a leather chair becomes the focal point of the decor, an invitation to relax and enjoy life with style.

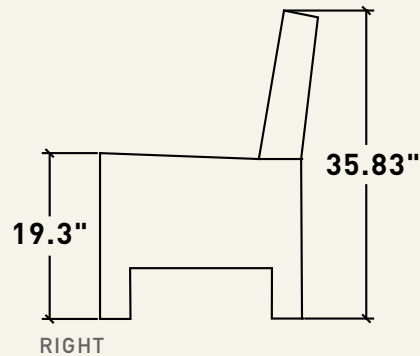
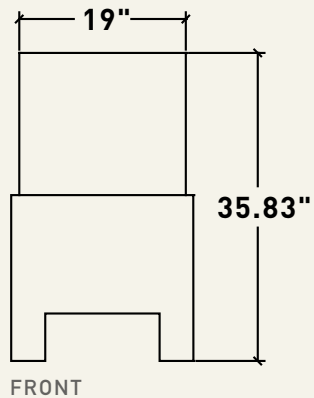
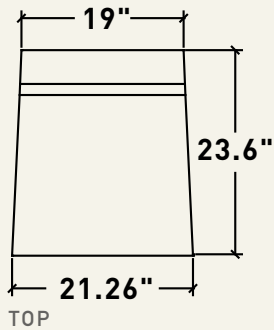

## DESCRIPTION MACAW CHAIR

- Leather chair.

1x	21.26" X 23.6" X 35.83"H	MATERIAL
	MACAW CHAIR	

LEATHER

# Senegal sofa



Our Senegal sofa embodies the perfect fusion of classic and timeless, making it a versatile and elegant choice that seamlessly adapts to any style of decor.

You no longer need to worry about changing your furniture with seasonal trends, as the Senegal sofa will remain relevant and attractive in your home for many years to come.

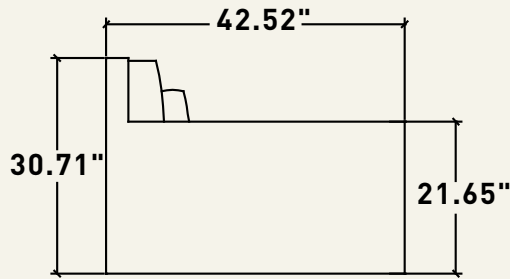

RIGHT

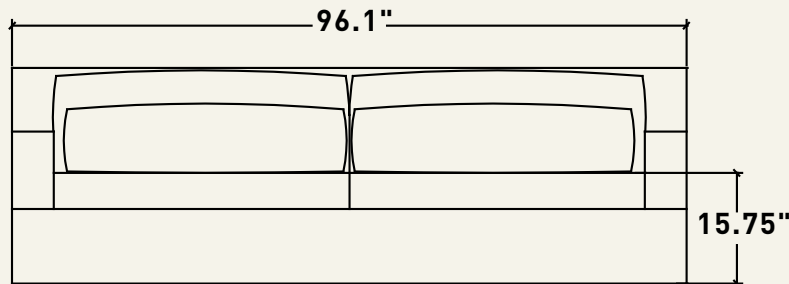

FRONT

## DESCRIPTION SENEGAL SOFA

- Textile sofa with a skirt.
- 4 back cushions for added comfort.

1x	96.1" X 42.52" X 30.71"H	MATERIAL
	SENEGAL SOFA	

FABRIC

# Lovebird sofa



The Lovebird, as its name suggests, is a loveseat with a seamless seat design that creates the illusion of a longer sofa, not to mention its elegant aesthetic.

Its timeless design exudes sophistication, while its versatility makes it the ideal complement for any environment, whether it's classic, modern, or eclectic.

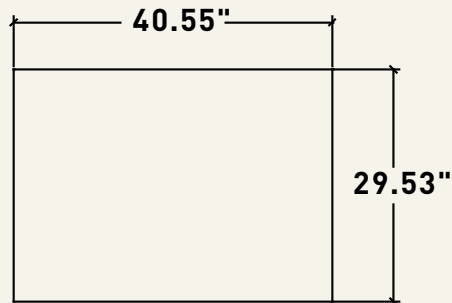

RIGHT

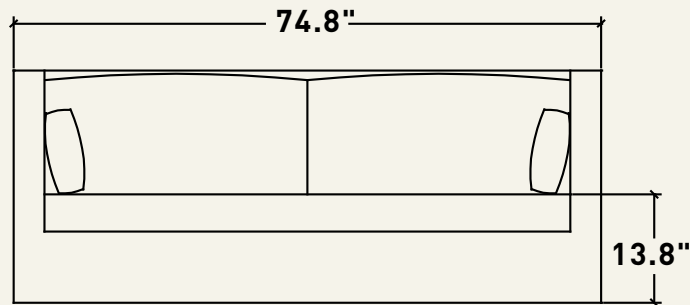

FRONT

## DESCRIPTION LOVEBIRD SOFA

- Textile sofa with a skirt.
- A single continuous seat cushion with no separations.
- 2 cushions to add comfort.

1x	74.8" X 40.55" X 29.53"H	MATERIAL
	LOVEBIRD SOFA	FABRIC



# PARROT

